



Quincy Street

28,021 SF  
Available

County Road H2

# For lease

Mounds View Business Park, Bldg F  
2220-2230 County Rd H2, Mounds View, MN

28,021 SF Available

 **JLL** SEE A BRIGHTER WAY

 **Capital  
Partners**

# Mounds View Business Park - Bldg F

2220-2230 County Rd H2, Mounds View, MN

## Building specifications

Mounds View Business Park - Building F is a high-image 62,685 SF office/warehouse building offering clean and functional suites with excellent interstate access.

<b>Building Size</b>	62,685 SF
<b>SF Available</b>	2,973 SF Office <u>25,048 SF Warehouse</u> <b>28,021 SF Total</b>
<b>Year Built</b>	1988
<b>Clear Height</b>	20'6"
<b>Loading</b>	Six (6) dock doors One (1) drive-in
<b>Power</b>	800 amps, 480-volt, 3-phase
<b>Column Spacing</b>	32' x 42'
<b>2025 Est. Tax/CAM</b>	\$2.05 PSFCAM <u>\$2.78 PSF Tax</u> <b>\$4.92 PSF Total</b>
<b>Available</b>	1/1/2026

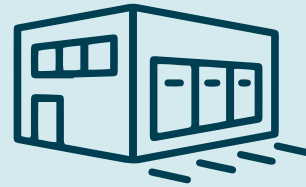

- High-image business park setting
- Large employee base in area
- Fiber optic cabling available
- Easy access; block away from I-35, I-694 and Hwy 10
- Fully sprinklered space
- 100% air-conditioned



# Floor plan

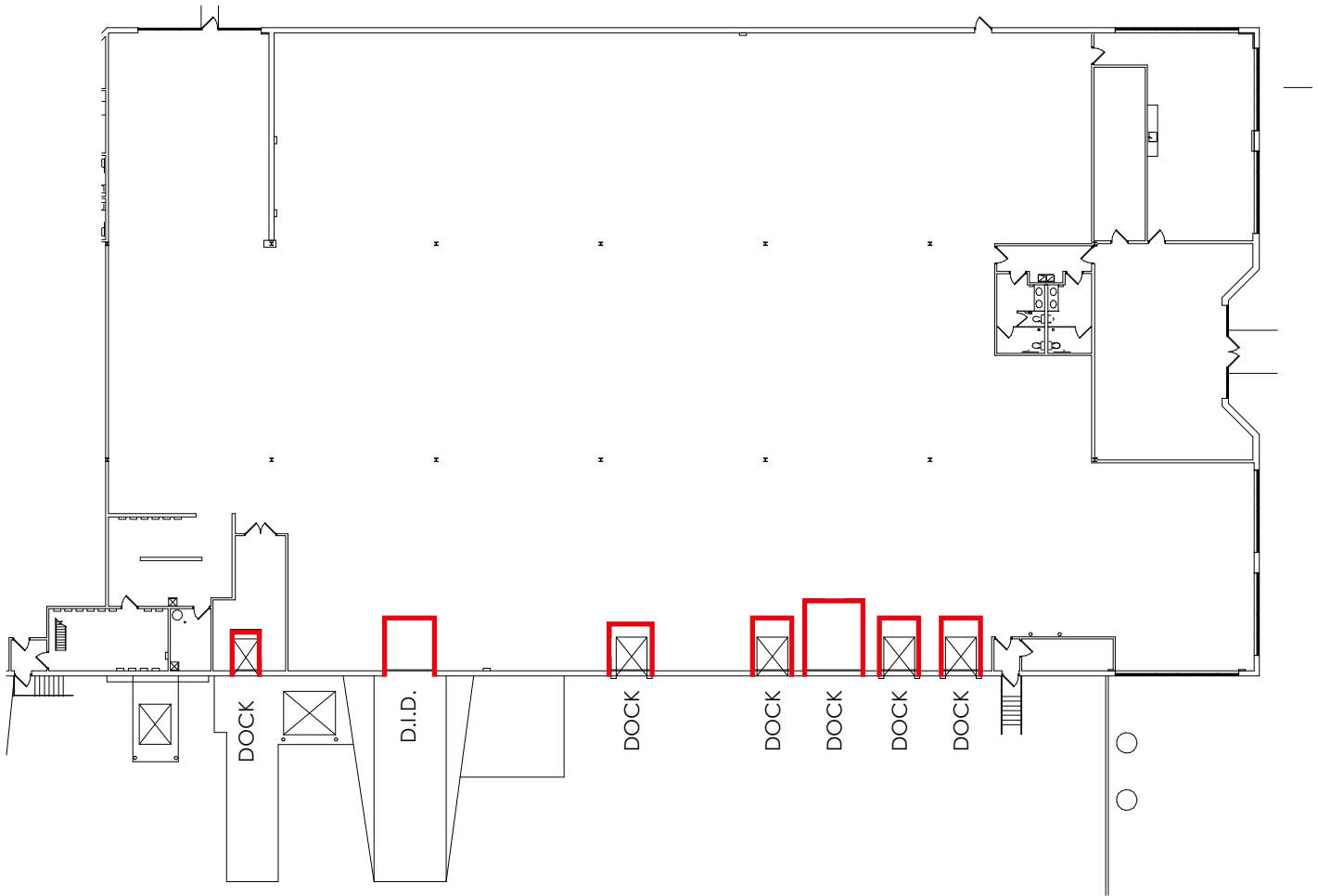

## **Suite 5275**

2,973 SF Office

25,048 SF Warehouse

**28,021 SF Total**

Six (6) dock doors with levelers

One (1) drive-in

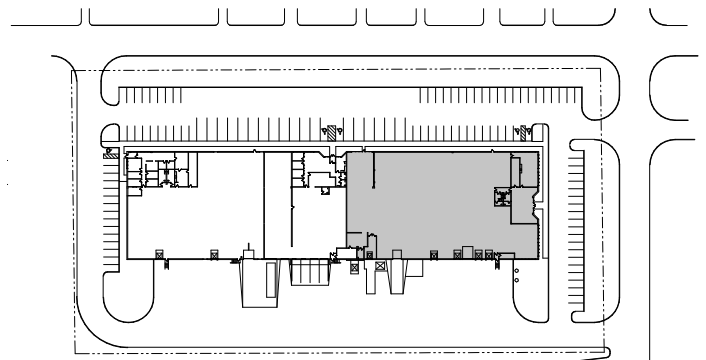

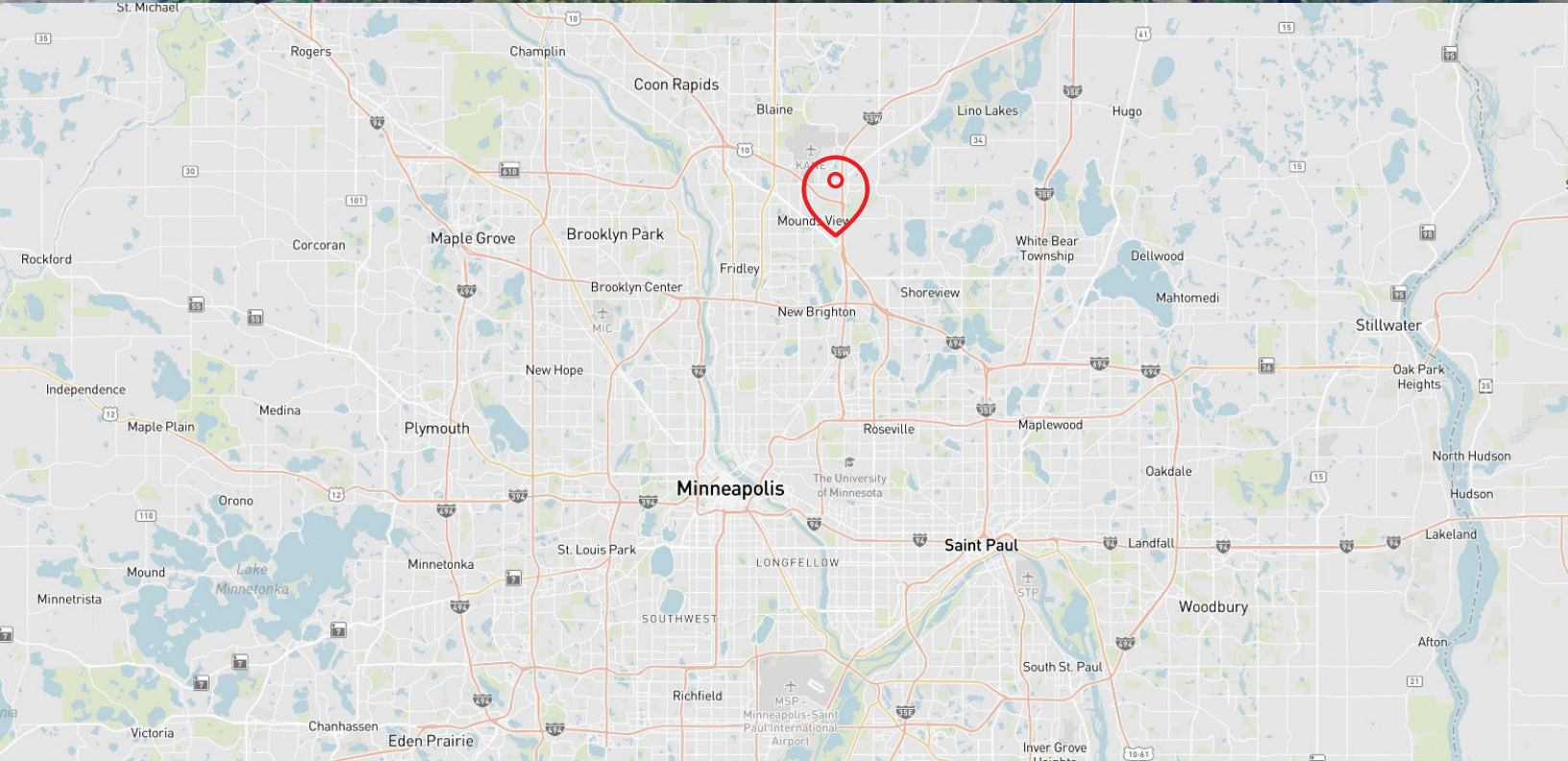

**JLL** SEE A BRIGHTER WAY

**Eric Batiza, SIOR**  
Managing Director  
+1 612 217 5123  
eric.batiza@jll.com

**Dan Larew, CCIM SIOR**  
Managing Director  
+1 612 217 6726  
dan.larew@jll.com

**JLL**  
250 Nicollet Mall  
Suite 1000  
Minneapolis, MN 55401