

For Lease

CBRE

Eagan Industrial Warehouse

1170 Eagan Industrial Road, Eagan, MN



Contact Us

Bryan Van Hoof
Senior Vice President
+1 952 924 4624
bryan.vanhoof@cbre.com

Jeff Przytarski
First Vice President
+1 952 924 4895
jeff.przytarski@cbre.com



CBRE

1170 Eagan Industrial Road | Eagan, MN

For Lease

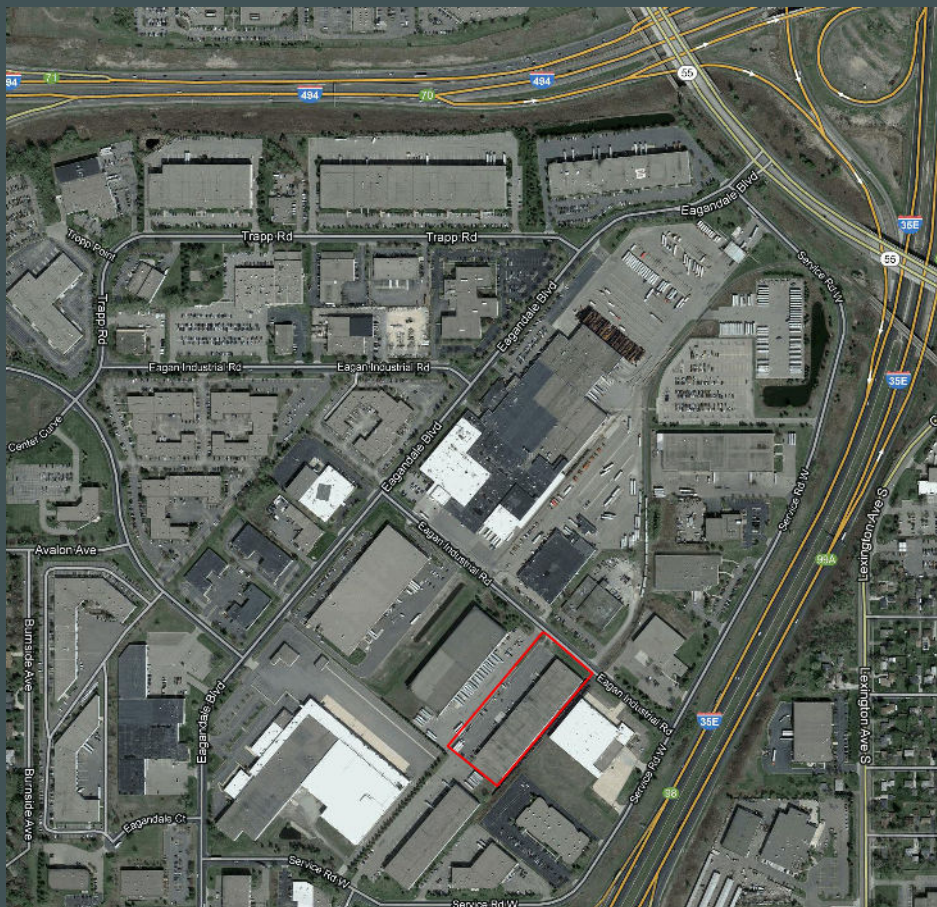

- Rail Serviced
- Excellent Access to I-35E and I-494
- Minneapolis/St. Paul Airport less than 10 minutes away

PROPERTY FEATURES

+TOTAL BUILDING: 96,372 SF AVAILABLE SPACE

+CLEAR HEIGHT: 20'

+SUITE N01

+ COLUMN SPACING: 30' x 40'

-14,260 SF Total

+ YEAR BUILT: 1969

– 13,245 SF Whse

+SPRINKLER: ESFR

–1,015 SF office

+2023 TAX/CAM: \$2.83 PSF

-3 Dock Doors

+RATES: Negotiable

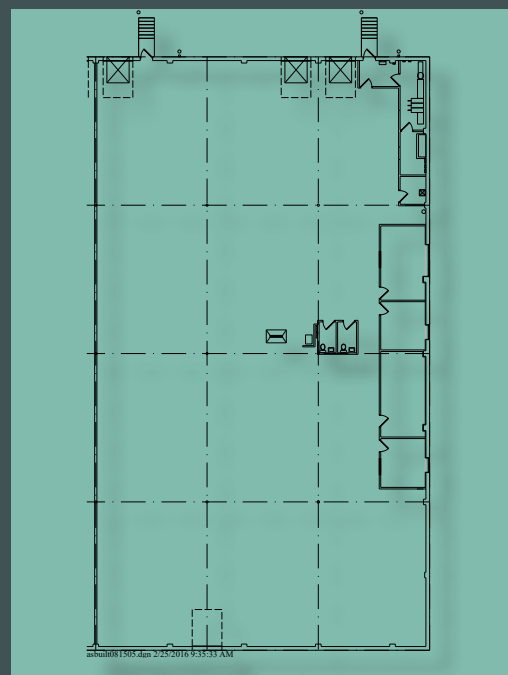

© 2022 CBRE, Inc. All rights reserved. This information has been obtained from sources believed reliable, but has not been verified for accuracy or completeness. You should conduct a careful, independent investigation of the property and verify all information. Any reliance on this information is solely at your own risk. CBRE and the CBRE logo are service marks of CBRE, Inc. All other marks displayed on this document are the property of their respective owners, and the use of such logos does not imply any affiliation with or endorsement of CBRE. Photos herein are the property of their respective owners. Use of these images without the express written consent of the owner is prohibited.

CBRE